

LC/LD PUMPS
INTERNAL SEAL
 LC/LD Series Pumps

AMPCO PUMPS COMPANY
 PARTS BREAKDOWN

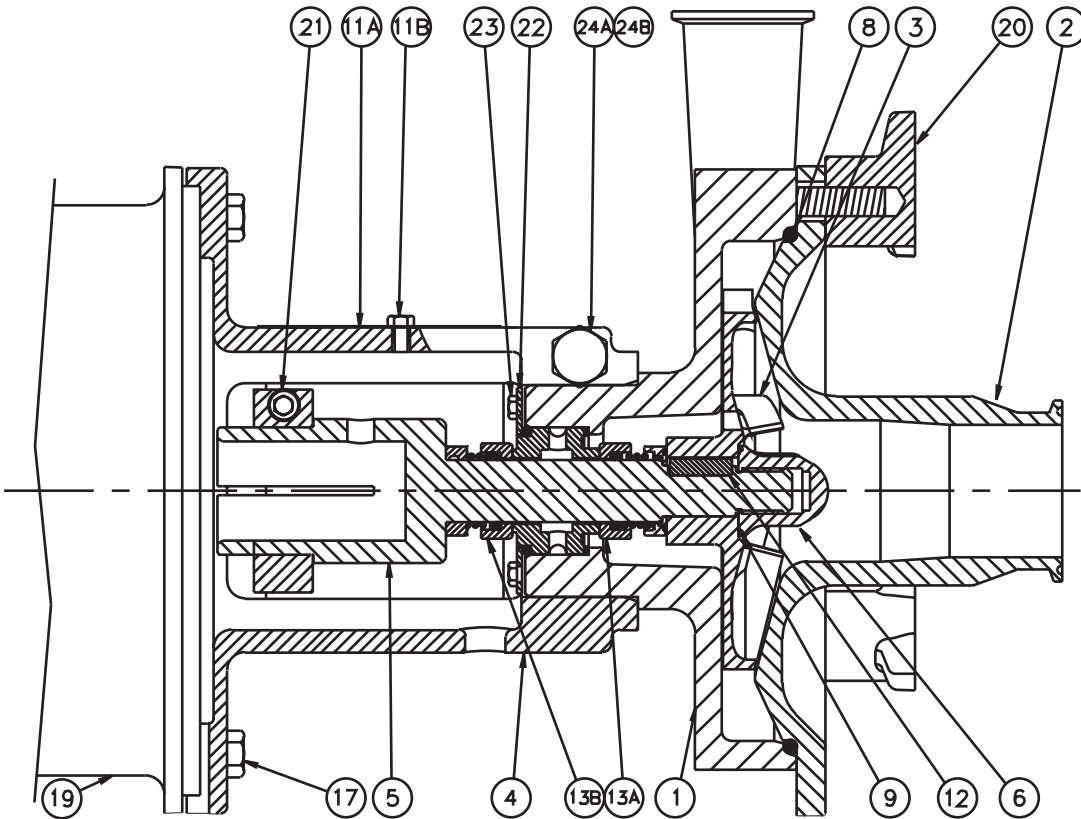

DETAIL NO.	REQ. NO.	PART NAME
24B	1	ADAPTER TIGHTENING BOLT
24A	1	ADAPTER NUT
23	4 ²	CAP SCREW (RETAINING RING)
22	1	RETAINING RING
21	1	SHAFT COLLAR
20	X ³	STAR NUT
19	1	MOTOR
17	4	CAP SCREW (MOTOR/ADAPTER)
16 ¹	2	DRIVE SCREW
15 ¹	1	NAME PLATE
13B	1	DOUBLE MECHANICAL SEAL (for LD)
13A	1	SINGLE MECHANICAL SEAL (for LC)
12	1	IMPELLER KEY
11B	1	SHAFT GUARD CAP SCREW
11A	1	SHAFT GUARD
9	1	GASKET (IMPELLER SCREW)
8	1	O-RING (CASING/COVER)
6	1	IMPELLER SCREW
5	1	STUB SHAFT
4	1	ADAPTER
3	1	IMPELLER
2	1	COVER
1	1	CASING

¹NOT SHOWN

²(6) SOCKET HEAD SET SCREWS FOR 250 FRAME

³STAR NUT QUANTITY VARIES WITH PUMP MODEL

NOTE: Please be sure to always include pump type, size, and serial number with any reference to above numbers and names.

