

ZC2/ZCH2 PUMPS

1 $\frac{1}{2}$ x1 $\frac{1}{2}$, 2x2, 3x2, 4x3L, 4x3C, 5x4

AMPCO PUMPS COMPANY PARTS BREAKDOWN

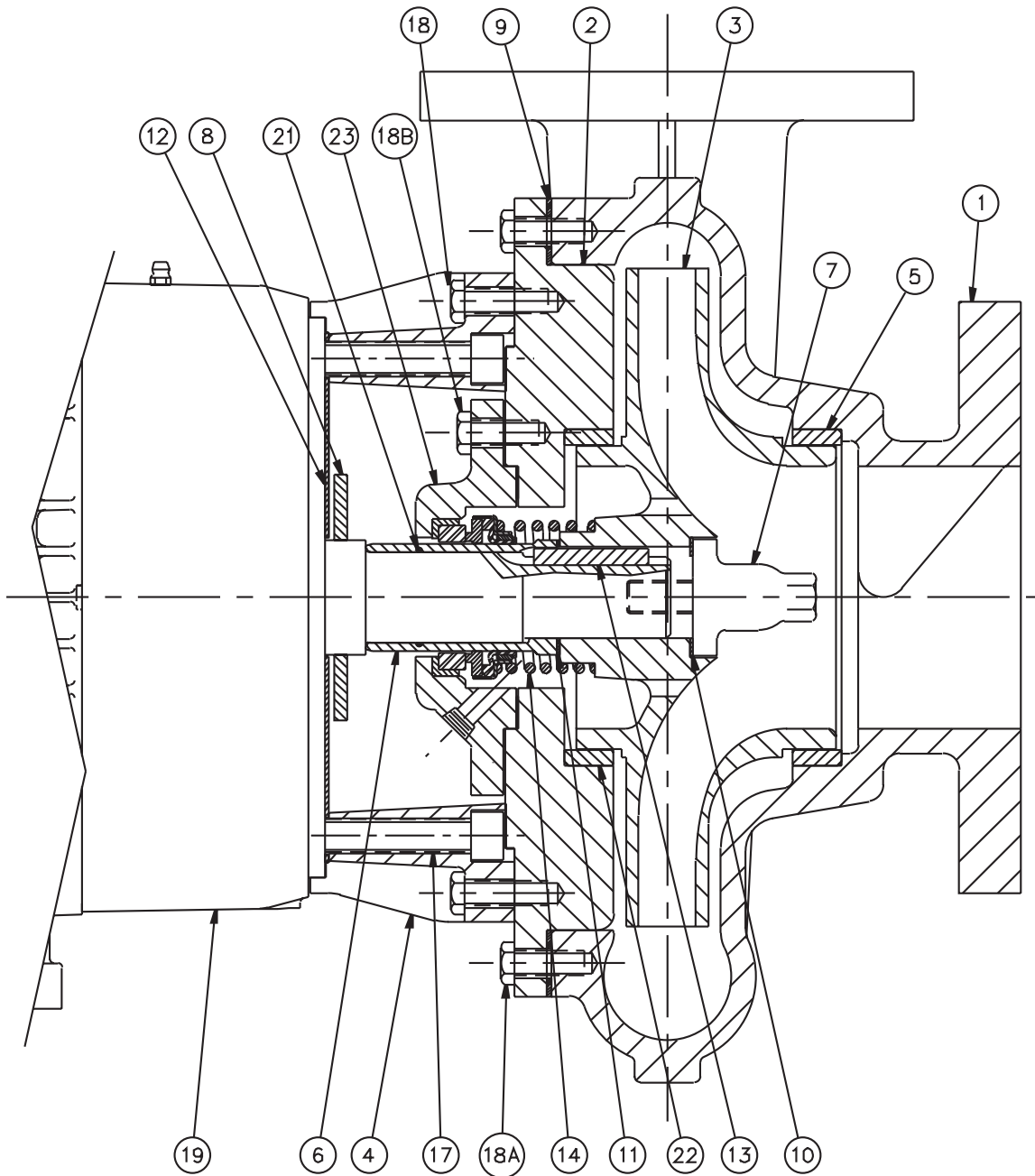

| DETAIL NO. | REQ. NO. | PART NAME |
|-----------------|----------------|-----------------------------------|
| 24 | 1 | STUFFING BOX GASKET |
| 23 | 1 | STUFFING BOX |
| 22 ³ | 1 | WEAR RING (COVER) |
| 21 ² | 1 | O-RING (SHAFT/SLEEVE) |
| 20 ¹ | 2 | PIPE PLUG (OPTIONAL) |
| 19 | 1 | MOTOR |
| 18B | 4 | CAP SCREW (COVER/STUFFING BOX) |
| 18A | X ⁴ | CAP SCREW (CASING/COVER) |
| 18 | 8 | CAP SCREW (COVER/ADAPTER) |
| 17 | 4 | CAP SCREW (MOTOR/ADAPTER) |
| 16 ¹ | 2 | DRIVE SCREW |
| 15 ¹ | 1 | NAME PLATE |
| 14 | 1 | MECHANICAL SEAL |
| 13 | 1 | IMPELLER KEY |
| 12 | 1 | SPLASH PLATE |
| 11 | 1 | GASKET (SLEEVE/IMPELLER) |
| 10 | 1 | GASKET or O-RING (IMPELLER SCREW) |
| 9 | 1 | GASKET (CASING/COVER) |
| 8 | 1 | SLINGER |
| 7 | 1 | IMPELLER SCREW |
| 6 | 1 | SHAFT SLEEVE |
| 5 | 1 | WEAR RING (SUCTION) |
| 4 | 1 | ADAPTER |
| 3 | 1 | IMPELLER |
| 2 | 1 | COVER |
| 1 | 1 | CASING |

¹NOT SHOWN

²ZCH2 ONLY

³NOT ON 1 $\frac{1}{2}$ x1 $\frac{1}{2}$

⁴8-1 $\frac{1}{2}$ x1 $\frac{1}{2}$, 2x2 12-3x2, 4x3L, 4x3C, 5x4

NOTE: Please be sure to always include pump type, size, and serial number with any reference to above numbers and names.